

**THEOMETRICS**

Bringing BIM to the Field

11 Hudson Square  
497 Canal Street  
New York, NY 10013

Phone: 212.627.8220  
Fax: 212.691.9505

[www.theometrics.com](http://www.theometrics.com)

### Customer

Levine Builders  
42-09 235th Street  
Douglaston, NY  
Phone: 718.224.7147  
[www.levinebuilders.net](http://www.levinebuilders.net)

### Construction Manager

Levine Builders

### Developer

Douglaston Development's

### Electrical Contractor

Polo Electric Corporation

## PROJECT: 316 11th Avenue

3D Pile Placement Deviation Study

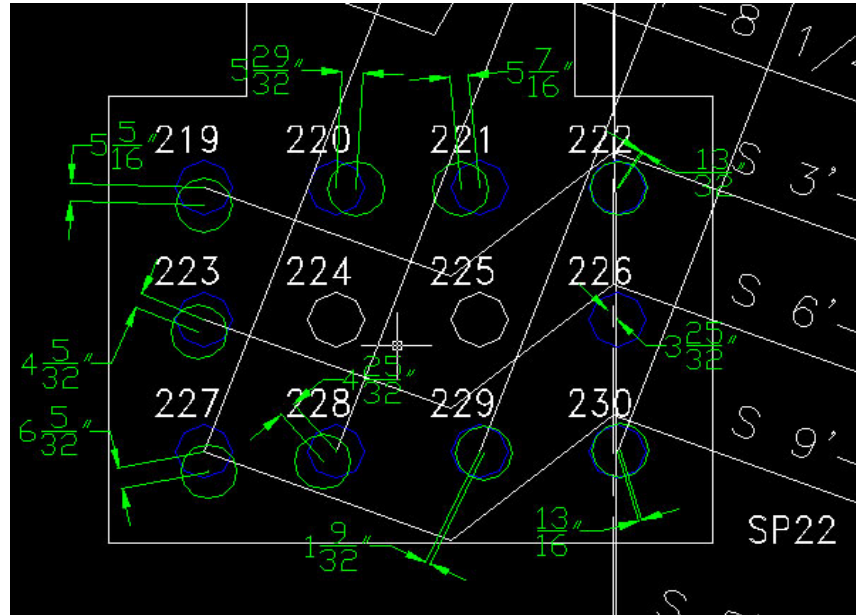

### Project Overview

316 11th Avenue is a 369-unit luxury residential rental building located on 11th Avenue and 30th Street in the special West Chelsea District, High Line Transfer Corridor.

### Scope of Work

3D Pile Placement Deviation Study

Theometrics was called upon to conduct a 3D Pile Placement Deviation study on the project: a capture of the location of each pile already placed as well as the survey reference already established on site. The CAD drawing was automatically generated in the field and was then aligned to the engineering drawing, making it possible to visually and measurably compare the actual pile placement to the proposed pile placement. This efficient process helped Levine Builders avoid critical structural issues and resulted in greater accuracy, increased production, and reduced construction cycle time.

### THEOMETRICS

*Theometrics is the art and science of precision measurement and navigation in and on construction sites. Our innovative technology navigates users with laser-sharp accuracy, from any point, on any CAD drawing or BIM model, to the exact specified field location. Theometrics' technology also enables exact, automated measurement and creation of real-time 2D or 3D CAD drawings in the field. Theometrics is the first and only company in the world to establish this Missing Bridge™ between CAD and the field: the transfer of CAD design precision to and from the construction site in real-time.*

