



THEOMETRICS

Bringing BIM to the Field

11 Hudson Square
497 Canal Street
New York, NY 10013

Phone: 212.627.8220
Fax: 212.691.9505

www.theometrics.com

Customers

welsbach Electric Corporation
(An Emcor Company)
111-01 14th Avenue
College Point, NY
Phone: 718-670-7900
www.welsbachelectric.com

Associate RA, LEED

Yetsuh Frank

Emcor Group

Paul Becker

Welsbach Electric Corporation

Ken Brouwer
Lew Streppa

Site Foreman

Keith Barfoot

PROJECT: Pavonia Path Station

Equipment Inventory & Facility
Measurement As-Built Layout

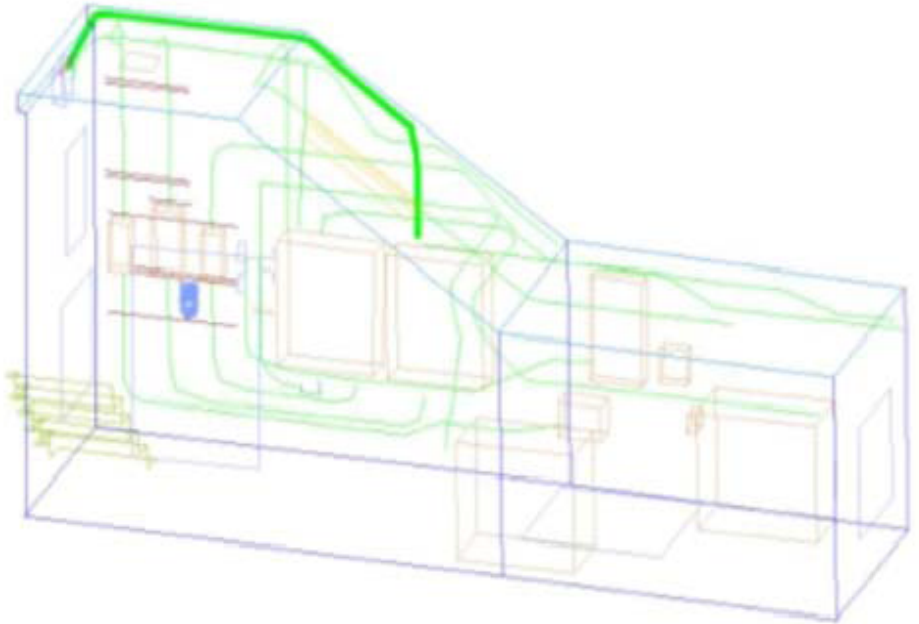

Project Overview

The NJ Port Authority Pavonia Station Communications Room required drawings of PATH facilities and mechanical rooms to simplify building modifications.

Scope of Work

Equipment Inventory & Facility Measurement As-Built Layout Theometrics was requested by Welsbach Electric to provide As-Built Studies of all PATH facilities and mechanical rooms in order to create a library of drawings for in-office reference. The dimensionally accurate 3D studies that Theometrics created allow changes and improvements to be made using AutoCAD first, eliminating the need to send crews into the field to measure for each alteration. The .DWG files clearly label and identify all equipment in the rooms for easy reference.

THEOMETRICS

Theometrics is the art and science of precision measurement and navigation in and on construction sites. Our innovative technology navigates users with laser-sharp accuracy, from any point, on any CAD drawing or BIM model, to the exact specified field location. Theometrics' technology also enables exact, automated measurement and creation of real-time 2D or 3D CAD drawings in the field. Theometrics is the first and only company in the world to establish this Missing Bridge™ between CAD and the field: the transfer of CAD design precision to and from the construction site in real-time.

